

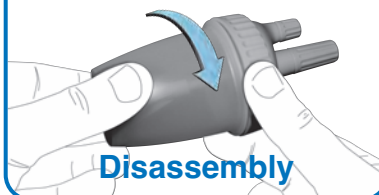

Fill-FLOTAC

Veterinary Parasitology and Parasitic Diseases
Department of Veterinary Medicine and Animal Productions
University of Naples Federico II
Via della Veterinaria, 1 - 80137 Naples, Italy
Tel. +39 081 2536283 - cringoli@unina.it

1
Unscrew the lid



Disassembly

2
Unscrew the bigger cap

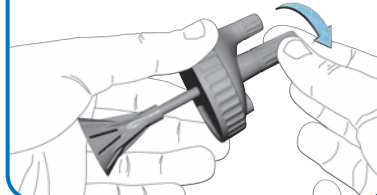

3
Unscrew the smaller cap

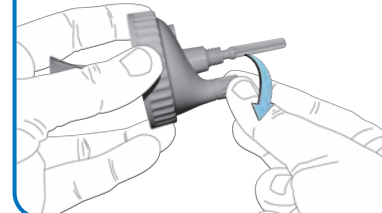

4
Remove the
cone/collector

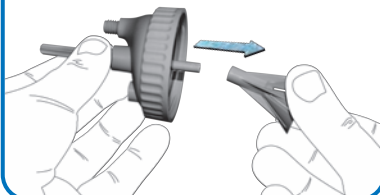

5
Remove the pole

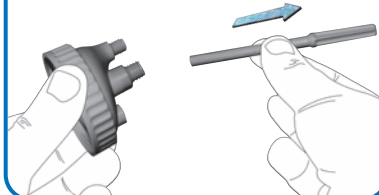

6
Insert the device to
remove the filter and
push

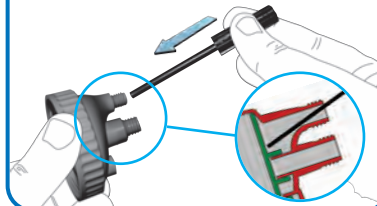

7
Remove the filter and
clean all the devices

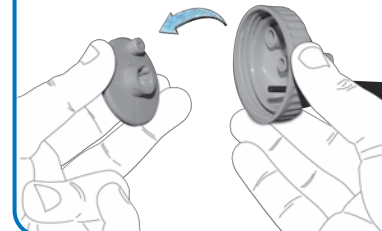

Fill-FLOTAC



Assembly

1
Put the filter into the lid

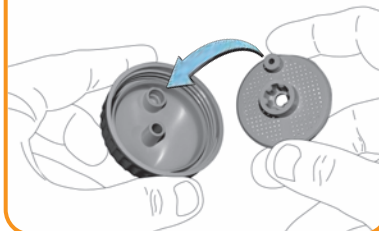

2
Put the pole inside the lid

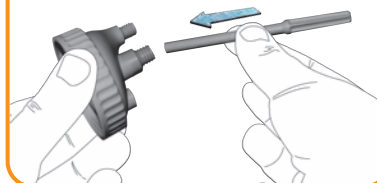

3
Connect the
cone/collector under
the pole

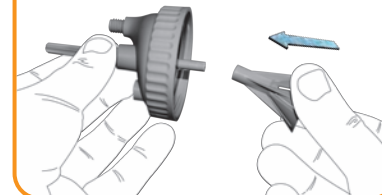

4
Screw the smaller
cap on the lateral hole

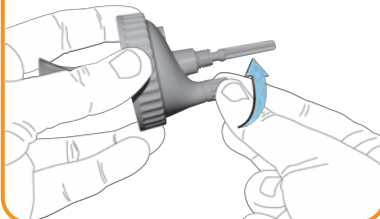

5
Screw the bigger cap
on the central hole

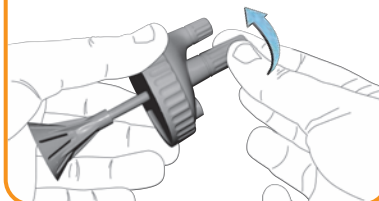

6
Screw the lid

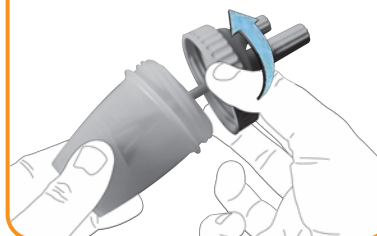

Fill-FLOTAC

